



ICEU146

Features and Benefits

- Produces clear, long-lasting shot-style cubes.
- Space-saving 535 mm wide undercounter design.
- Produces up to 72 kg of ice per day.
- Built-in storage bin stores up to 40 kg.
- Constructed from sturdy, corrosion-resistant stainless steel and fingerprint-proof plastic.
- Ideal for any undercounter or bar application.
- Contemporary, elegant design.

Options & Accessories

WATER FILTERS		
Ice Machine Model	Manifold	
	System	Replacement
ICEU146AS	CD10	CD100P

Ice Maker Warranty

Every Ice-O-Matic ice maker is backed by a warranty that provides both parts and labor coverage.

- Two years Parts
- Two years Labor

Ice Form



BISTROT CUBE

SHOT STYLE	
Height (mm)	30.5
Diameter (mm)	29.5



ICEU146 - SELF CONTAINED MACHINE



ICEU146 SELF CONTAINED MACHINE

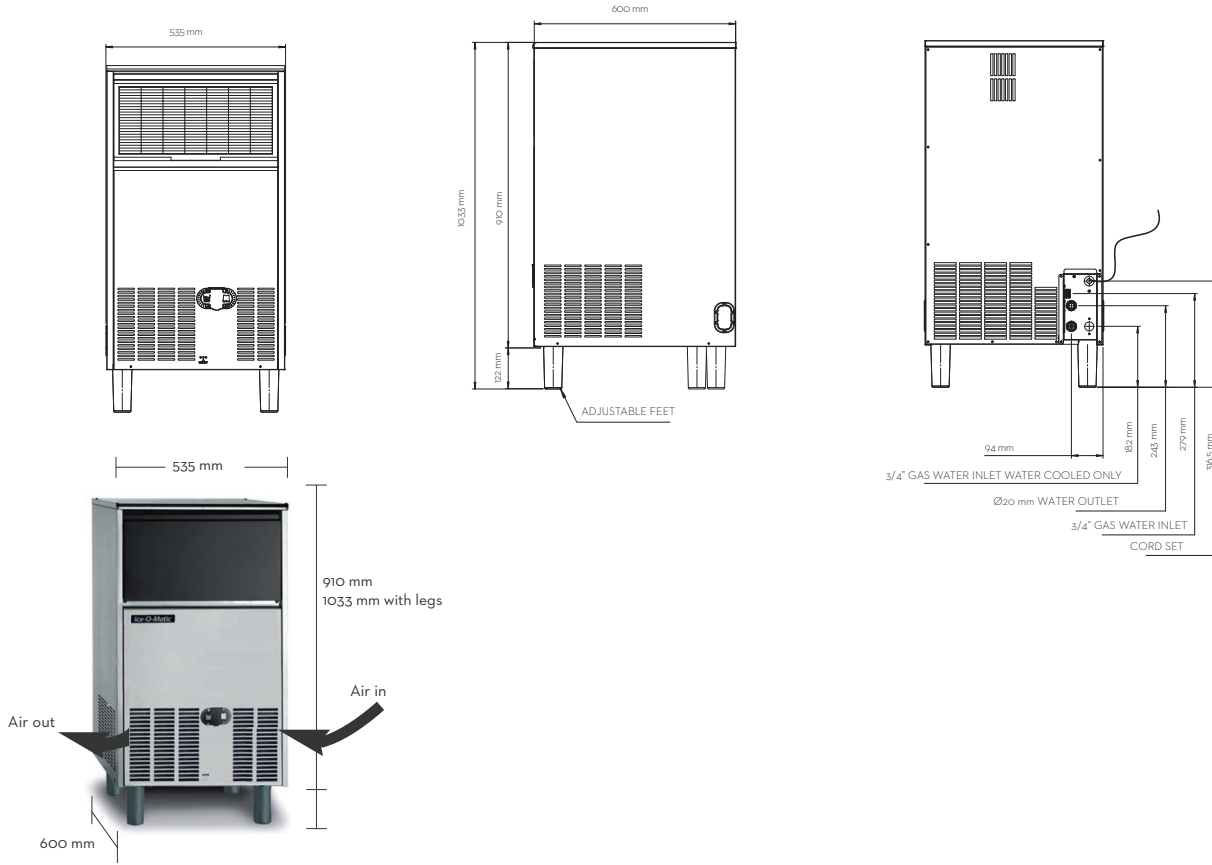

Operating Requirements

	MINIMUM	MAXIMUM
	50 Hz	
Ambient Temp. Range Air	10°C	43°C
Water Temp.	5°C	38°C
Water Pressure	0.8 BAR	5 BAR
Electrical Voltage	230V/50Hz/1ph	

Dimensions

ALL MODELS	
W x D x H (mm)	535 x 600 x 1,033

Specifications

Model Number	Cond. Unit	Ice Production per 24 hrs 21°C air/ 10°C water (kg)	Storage Capacity (kg)	Water Consumption (Lt/60 mins)	Electric Consumption (kWH/24hr)	Voltage Characteristics
ICEU146AS	Air	72	40	8.5	14.6	230/50/1

NOTES:

Approx. Shipping Weight kg: 52
Refrigerant Type: R134A

All specifications and performance data are subject to normal manufacturing variances.